

THE PLACE TO MEET

SPRINGHILL SUITES® ATLANTA AIRPORT GATEWAY

2091 Convention Center Concourse | College Park, Georgia 30337
770.907.8880 | SpringHillSuitesAtlantaAirportGateway.com

SPRINGHILL SUITES
BY MARRIOTT





WELCOME TO A COMBINATION OF CONVENIENCE AND COMFORT

Refresh your routine at the SpringHill Suites by Marriott® Atlanta Airport Gateway. Built for work or play, our stylishly designed suites feature additional space to do as you please. Start your day with a complimentary hot and fresh breakfast each morning and stay connected with complimentary high-speed Internet access throughout the hotel. Our LEED® certified hotel is conveniently located at Hartsfield-Jackson Atlanta International Airport via the ATL SkyTrain and easily accessible to downtown by the MARTA rail. Spend less time traveling and more time making the most of your stay.

LOCATION

Situated just 10 minutes from Atlanta and next to the Georgia International Convention Center, Chick-fil-A Headquarters, Delta Airlines Headquarters, Porsche Driving Experience & Connected to Hartsfield-Jackson Atlanta International Airport via the ATL SkyTrain.

FACILITIES & SERVICES

6 floors | 147 suites | Exercise room | Complimentary hot breakfast buffet | Business center | Boarding pass station | Complimentary Internet access throughout the hotel | Wired and wireless Internet access in guest rooms

GUEST ROOM AMENITIES

Microwave | Refrigerator | West Elm trundle sofa bed | Coffee maker/tea service | Luxury bedding – crisp linens, thicker mattresses, custom comforters, fluffier pillows | Hair dryer | Wet bar

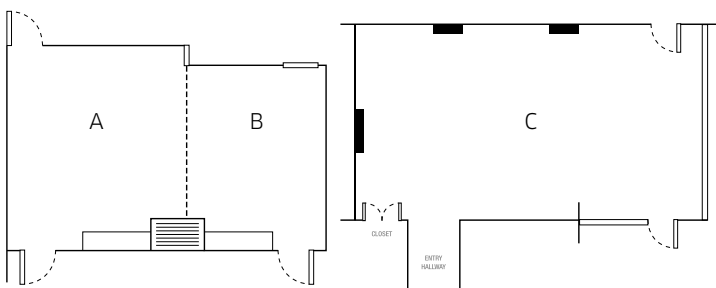

MEETING FACILITIES

- 3 meeting rooms
- 2,051 square feet of total meeting space
- Largest meeting room is Meeting Room C with 1,380 sq. ft. of space and maximum seating capacity of 120

ATTRACTIONS

Delta Flight Museum | Atlanta Motor Speedway | Camp Creek Marketplace | College football Hall of Fame | National Center for Civil Human Rights | Centennial Olympic Park | CNN Center | Fernbank Museum of Natural History | Georgia World Congress Center | Six Flags Over Georgia | World of Coca-Cola | Georgia Aquarium | Martin Luther King Jr. Center | Carter Center | Zoo Atlanta | Porsche Driving Experience | Piedmont Park | Margaret Mitchell House | High Museum of Art | Fox Theatre | Mercedes Benz Stadium | Stone Mountain Park

LOCAL RESTAURANTS

Champions Beer Garden & Patio | Hickory & Hazel Southern Table & Bar | Flights Wine & Bourbon Bar | The Pecan | The Feed Store | Noodle | Brake Pad | The Manchester Arms | Bentleys Steakhouse | Simon's Steakhouse | T.F.I. Friday's | Ruby Tuesday | Chili's | Jason's Deli | Five Guys | Fina Italian Bistro | Our Place | Johnny Carino's

DIRECTIONS

Using ATL SkyTrain from Airport: Take the ATL SkyTrain to GICC Gateway stop. Take the elevator down to the ground level. Hotel is just outside the station.

Driving from Airport: Follow signs for Camp Creek Parkway. Turn left at the Georgia International Convention Center onto Convention Center Concourse. The hotel will be on the left.

MARRIOTT BONVOY™

Marriott Bonvoy opens the door to 32 extraordinary hotel brands and endless experiences. Unlock a world of exclusive member benefits, including complimentary Wi-Fi, members-only rates, and points that take you places. The journey starts in the Marriott Bonvoy App. Where Can We Take You?

MEETING ROOM	DIM. (L x W)	AREA (ft ²)	HEIGHT	THTR.	CLASS.	CONF.	U-SHAPE	REC.	BANQ.
A	14' x 25'	336	11'	30	15	16	14	30	30
B	14' x 21'	335	11'	30	15	16	14	30	30
C	46' x 30'	1,380	9'	80	48	38	36	120	80
A & B	28' x 25'	671	11'	72	36	32	30	60	60